

H₂O Glue®

AQUA-BONDER

Underwater Adhesive

Repairs made easier...

LP 50 Gun

ASSEMBLY

1. If retaining plate resembles the gun style in Figure 3, remove retaining plate. Raise retaining plate if it is attached to the gun. Hold plunger in hand such that the numbers indicating mix ratio are facing up. Hold gun in your hand as you would to dispense adhesive. Push up with thumb on lever at back of gun, then insert plunger with teeth down through front of gun.
2. Place adhesive cartridge in dispenser. Plunger must be completely retracted for cartridge placement. Since guns are designed for all mix-ratio cartridges, tabs molded in to cartridges permit placement only in the correct direction.
3. Once cartridge is seated, attach or close top retaining plate. Remove storage cap from cartridge. Level pistons by dispensing small amount of adhesive without mixer attached.
4. Attach static mixer by aligning mixer with nozzle opening. Lock mixer in place by turning clockwise until stop is reached.
5. Ensure complete mix of adhesive components by dispensing mixer's length of adhesive. A color stabilization will be noted when enough adhesive has been dispensed. At this point, adhesive should be uniformly mixed.

DISASSEMBLY

To remove the cartridge from gun assembly, lift lever on back of gun. Pull back on plunger to extract cartridge.

LP 50 Gun_use with Kit #1

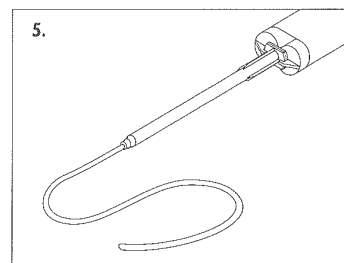
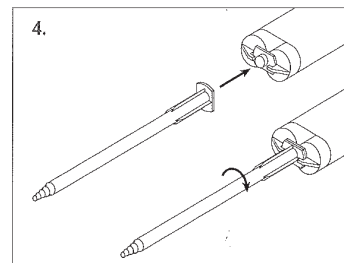
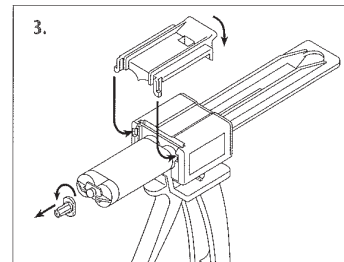
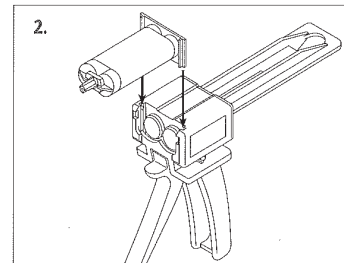
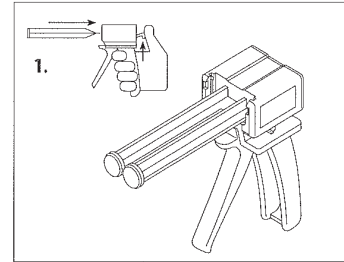

For additional information
please contact us at 1.800.220.1966.
Visit our website @
www.chemical-concepts.com or
www.H2Oglue.com