

Application: on boxed and tubular sections, on sheet-metal and non-metal sheets, plastic materials, brittle materials and other materials.
 Assembly: with specific manual, pneumatic, oleopneumatic or electric tools.

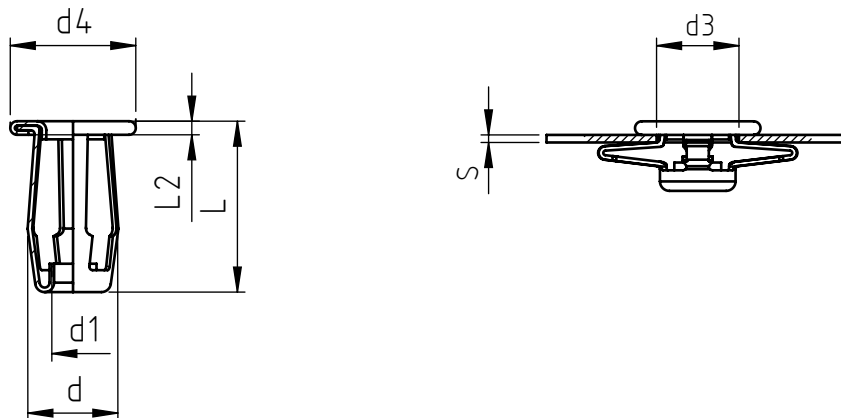

code steel	code stainless steel	grip S	metric thread d1	total length L	shank diameter d	max head diameter d4	head thickness L2	hole diameter d3
TC-F M4	--	0,4 ÷ 4,8	M 4	16,8	8,2	12,3	1,6	8,3
TC-F/L M4	--	4,8 ÷ 9,5		22,0				
TC-F M5	TCX-F M5	0,4 ÷ 4,8	M 5	18,4	10,1	14,5	1,6	10,3
TC-F/L M5	--	4,8 ÷ 9,5		23,2				
TC-F M6	--	0,4 ÷ 4,8	M 6	18,4	12	16,5	1,6	12,3
TC-F/L M6	TCX/L-F M6	4,8 ÷ 9,5		23,0				
TC-F M8	--	0,4 ÷ 4,8	M 8	21,0	15,2	18,5	2	15,5
TC-F/L M8	--	4,8 ÷ 8,0		25,0				
--	TCX/L-F M8	5,0 ÷ 12,0		25,5				

Non binding dimensions, expressed in mm.

Standard
 On demand
 Not manufactured

Material: steel TC-F__
 stainless steel TCX-F__

Finishing: steel: zinc-plated
 stainless steel: natural

Thread: metric

Example: threaded flower insert, steel, grip 2,0 mm,
 M 5 thread: TC-F M5

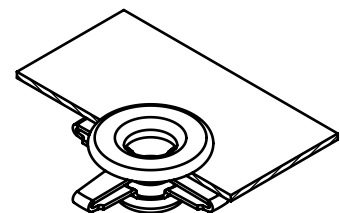

SPECIALINSERT® COMMITS ITSELF TO CONTINUOUSLY IMPROVE ITS PRODUCTS. IT RESERVES THE RIGHT TO CHANGE THEIR TECHNICAL AND STRUCTURAL CHARACTERISTICS WITHOUT PRIOR NOTICE. ALL RIGHTS ARE RESERVED AND THE DUPLICATE, EVEN PARTIAL, OF THESE DOCUMENTS, AS WELL AS ITS DISTRIBUTION TO THIRD PARTIES, ARE FORBIDDEN, UNLESS OTHERWISE AND EXPRESSLY AUTHORIZED BY SPECIALINSERT.